

DATA SHEET

TREKC M2 HIGH EDITION DENTAL UNIT

Ref. SFTYM2

CLASIFICACION DIRECTIVE 93/42

Class II a. Medical device

COMPOSITION



Imagen 1: Estructura de la unidad dental

1	Power Switch
2	Patient seat
3	Triple syringe
4	Polymerizing lamp
5	Suction Canulas
6	Cuspidor
7	Cup and napkin holder
8	Operating light

9	Hoses for rotary instruments
10	Luzzani triple syringe
11	Pneumatic micromotor
12	Scaler compatible with EMS
13	X-ray film viewer
14	Control panel and button panel
15	Instrument tray
16	Water group
17	Multifunction foot pedal

TREKC M2 HIGH EDITION DENTAL UNIT

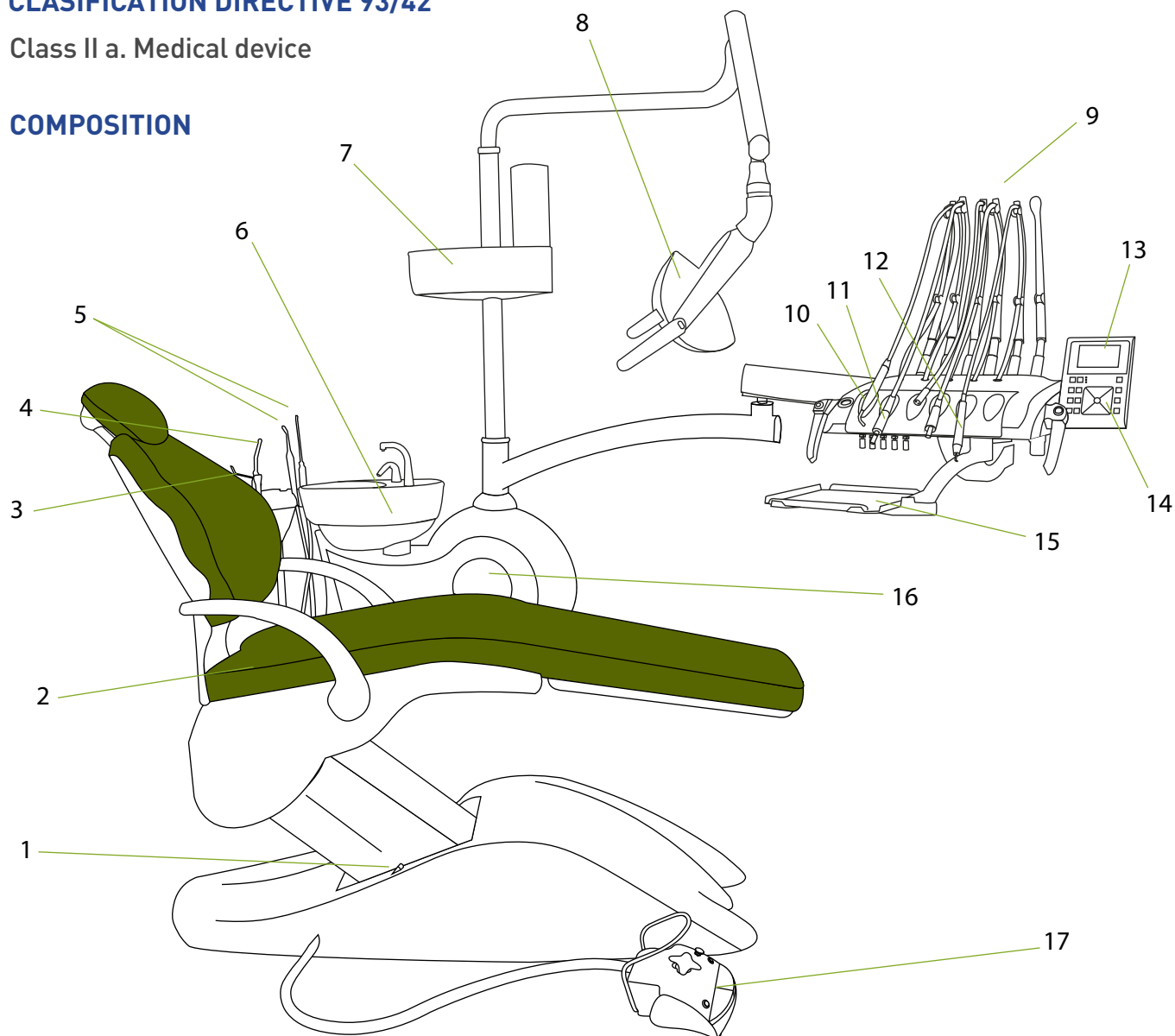
GENERAL FEATURES:

• Dentist tray:

- Continental delivery system with 5 housings, retractable:
 - Luzzani® Minilight triple water-air-spray syringe.
 - 1 Drive Air Hose with Midwest 4 micromotor.
 - 2 Driver Air Midwest 6 hoses with LED light.
 - Electronic ultrasound scaler with LED light compatible with EMS®.
- Touch control panel:
 - Chair movement and movement to working positions: programmable memories (9 positions).
 - Operating light control.
 - Cup filling guide.
 - Syringe water heater.
 - Automatic sweeping of the cuspidor.
- Water/air regulation system of each hose.
- Pneumatic brake with handle in stainless steel AISI316 and silicone hose retaining device.
- X-ray film viewer.

• Assistant tray:

- Rotary tray with Touch panel with controls:
 - Chair movement.
 - Cup filling guide and automatic cuspidor sweep.
- Includes 4 hoses.
 - 1 Triple syringe water-air-spray.
 - 1 LED polymerization lamp.
 - 2 suction hoses type Cattani®, with 2 suction cannulas: surgical and saliva ejector.

• Water group:

- Rotating porcelain cuspidor.
- Supported by the chair; it moves in tune with the chair.
- Incorporates water heater constant temperature 40°C.
- Mignon type cut-off valve (Inlet valve).
- Spittoon valve.
- Perfectly prepared for wet-ring suction, Dürr® or Cattani® type and easily adaptable to dry-ring suction.
- Tecnomed Italy pressure regulators, water, air and solid filters.
- Double distilled water tank (1 liter + 1 liter).
- Safety systems, active and passive.

• Motion system:

- Safety system in extreme movements, (chair and backrest lowering) and whenever the instruments are in use.
- Electro-pneumatic motor with up, down and compensated trendelenburg movements controlled from dentist tray, assistant tray and pedal.

• Foot pedal:

- Multifunction foot pedal: Joystick for movement control. Instrument control. Control button for dental unit position, switch for cuspidor water control and switch for air and water for handpiece.

• Lamp:

- 8000-45000Lx. Power of 23W. Progressive change of light intensity.

• Arm and headrest:

- Articulated arm , allow positioning in any operating area without interference.
- The headrest can be positioned upwards or downwards. Movements are made by hand at any angle. Can also be adapted for children by moving the headrest towards the backrest. Easy to use for people with reduced mobility.

• It includes:

- Stool with height and backrest adjustment.

TREKC M2 HIGH EDITION DENTAL UNIT

TECHNICAL FEATURES:

ELECTRICAL PARAMETERS		POWER SUPPLY	230V/ 50Hz
		POWER CONSUMPTION	1100W
		COMPONENTS	<ul style="list-style-type: none">X-Ray Viewer: 24Vac, 20WOperating Light: 12-24Vac, 50WWater Heater: 24Vac, 80W
		FUSE	<ul style="list-style-type: none">F250V/T3, 15AL F250V/T6,3AL
WATER/AIR SET UP		AIR	<ul style="list-style-type: none">Pressure: 600 - 800 kPaAir flow: > 50l/minNo oil
		WATER	<ul style="list-style-type: none">Pressure: 200 - 400 kPaWater flow: > 10l/min
		VACUUM	<ul style="list-style-type: none">Vacuum pressure: <{-}9kPaFlow> 300l/min
ROTARY INSTRUMENTS	TURBINE	AIR PRESSURE	220kPa (0.2MPa)
		SPEED	350 000 rpm
	MICROMOTOR	AIR PRESSURE	300kPa (0.3MPa)
		SPEED	18 000 rpm
LIGHTING FEATURES	OPERATORY LAMP	INTENSITY	8 000 a 45 000lux
		POWER	23W
	X-RAY VIEWER		2 000 lux
MOVEMENTS		VERTICAL MOVE	<ul style="list-style-type: none">Min: 500mmMax: 700mm
		BACKREST INCLINATION	105° a 170°
		HEAD EXTENSION	120 mm
		EXTENSION ANGLE	12°
		WORKSPACE	4m (L) x 2.6m (W) x 2m (H)
LOAD		DENTAL CHAIR	135kg
		INSTRUMENTS TRAY	+5kg
WATER HEATER TEMPERATURE			40°C (+-5°C)
FILTERS	WATER	PARTICLES SIZE	<90µm.
	AIR	PARTICLES SIZE	<25µm
ENVIROMENTAL WORKING CONDITIONS		TEMPERATURE	5°C a 40°C
		RELATIVE HUMIDITY	<80% R.H 86kPa - 106kPa
TRANSPORT CONDITIONS		TEMPERATURE	-25°C a 70°C
		RELATIVE HUMIDITY	<93% R.H 50kPa - 106kPa

TREKC M2 HIGH EDITION DENTAL UNIT

TECHNICAL FEATURES:

POWER SUPPLY	230V 50Hz, Power consumption: 1100W.
COMPRESSOR AIR PRESSURE/FLOW	500kPa, <50l/min
WATER FLOW PRESSURE	200kPa - 400kPa

TRANSPORT AND STORAGE CONDITIONS:

HUMIDITY:	≤ 80 %
TEMPERATURE:	-10 °C y 40°C



DIMENSIONS:

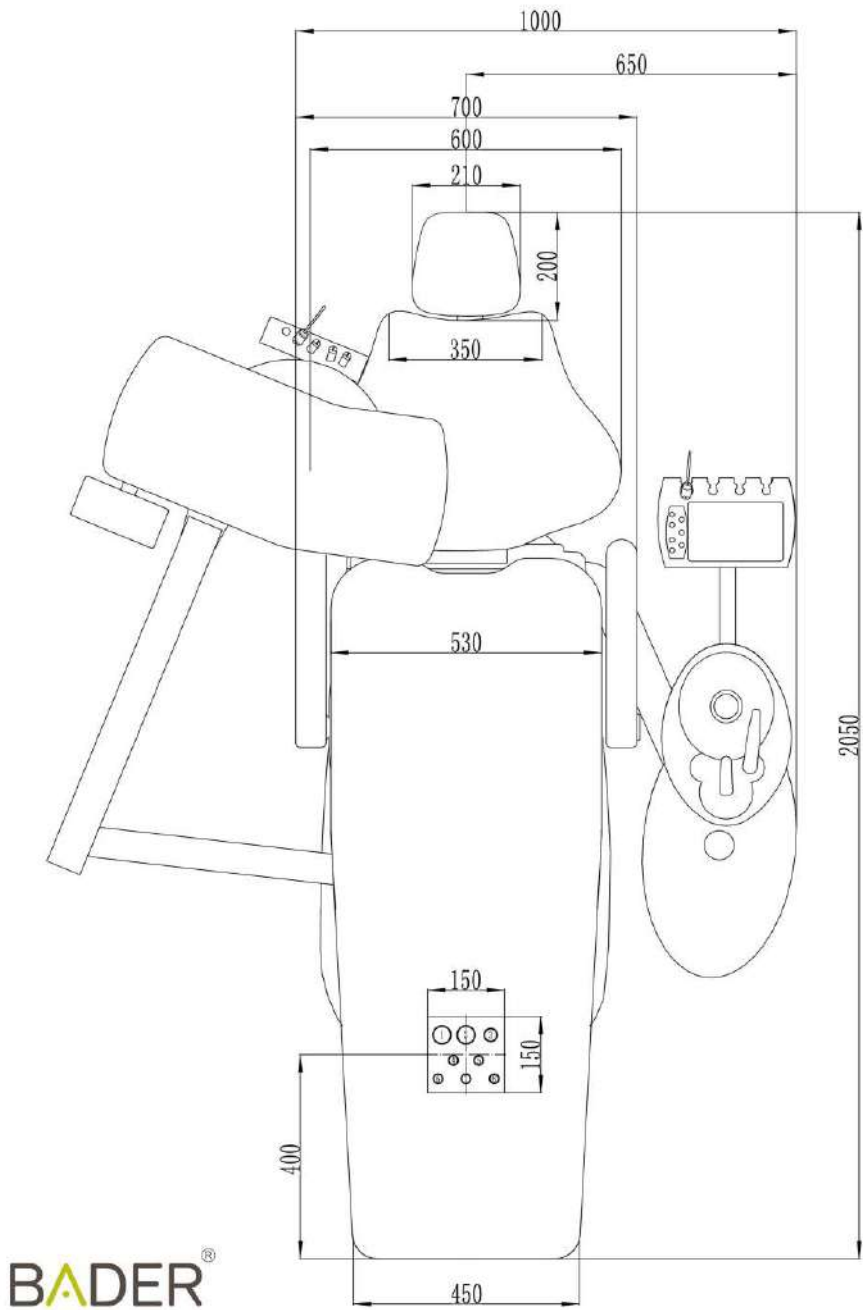

TREKC M2 HIGH EDITION DENTAL UNIT

INSTALLATION CONSIDERATIONS:

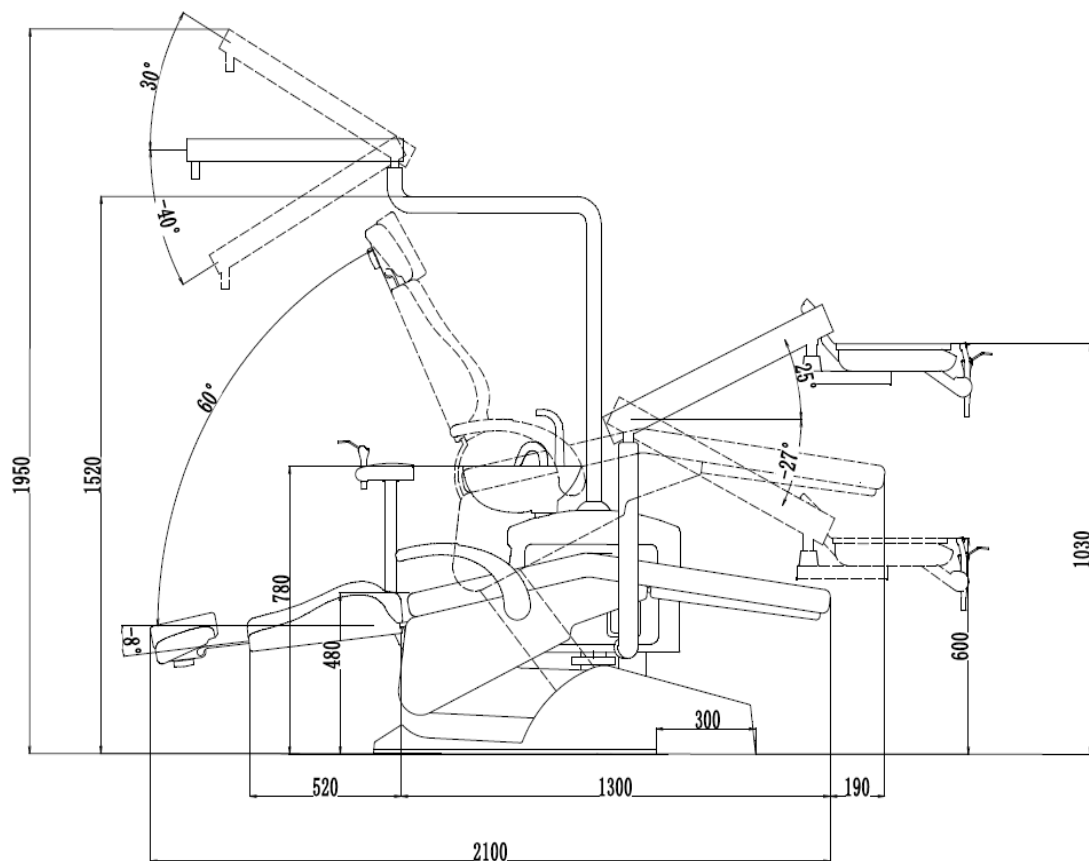
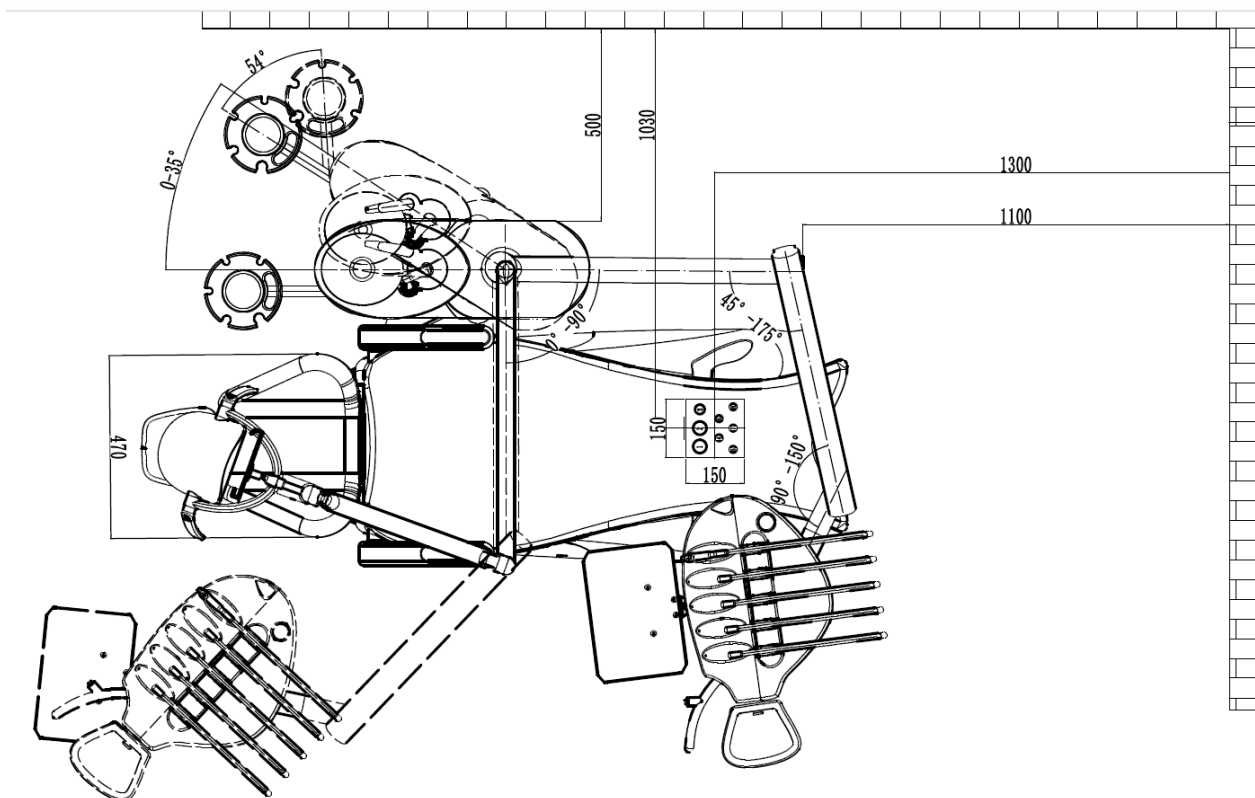

TREKC M2 HIGH EDITION DENTAL UNIT

INSTALLATION CONSIDERATIONS:

Connections to be made under the chair:

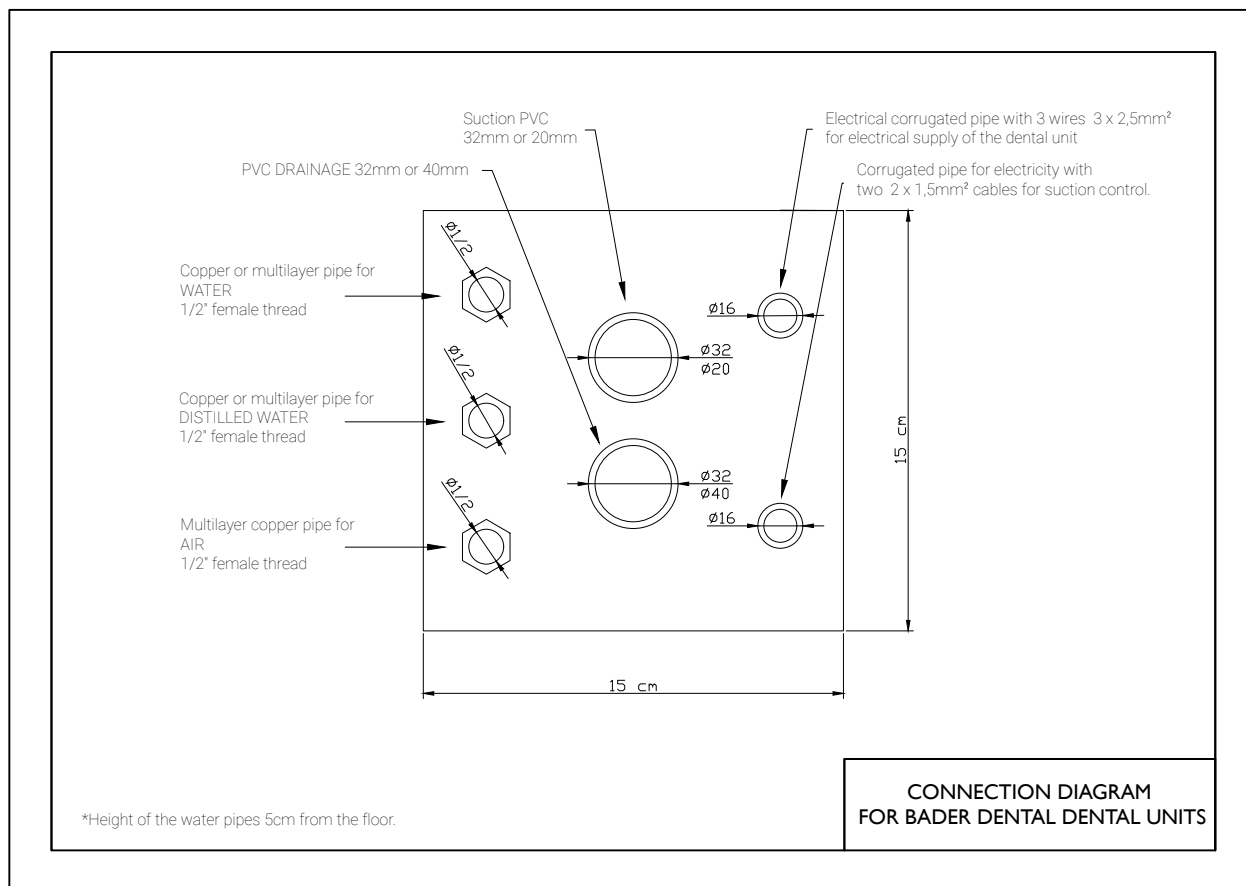

WIRING DIAGRAM CHAIR - COMPRESSOR - SUCTION UNIT - DRAINAGE:

