

## Ref. SFTYM1

## Class II a. Medical device

**MPOSITION**

Diagram illustrating the components of a dental chair in the 'MPOSITION' (likely 'Midposition'). The components are numbered 1 through 17:

1. Base/Frame
2. Seat
3. Backrest
4. Headrest
5. Headrest Adjustment Lever
6. Headrest Adjustment Lever
7. Headrest Adjustment Lever
8. Headrest Adjustment Lever
9. Headrest Adjustment Lever
10. Headrest Adjustment Lever
11. Headrest Adjustment Lever
12. Headrest Adjustment Lever
13. Headrest Adjustment Lever
14. Headrest Adjustment Lever
15. Headrest Adjustment Lever
16. Headrest Adjustment Lever
17. Headrest Adjustment Lever

1	Power Switch
2	Patient seat
3	Triple syringe
4	Polymerizing lamp
5	Suction Canulas
6	Cuspidor
7	Operating light
8	Cup and napkin holder

9	Water group
10	Triple syringe
11	Pneumatic micromotor
12	Scaler compatible with EMS
13	Hoses for rotary instruments
14	Dentist tray
15	Control panel and button panel
16	Instrument tray
17	Multifunction foot pedal

# HILUX M1 NEW GENERATION DENTAL UNIT

---

## GENERAL FEATURES:

### • Dentist tray:

- Continental delivery system with 5 housings, retractable:
  - Triple water-air-spray syringe.
  - 1 Drive Air Hose with Midwest 4 micromotor.
  - 2 Driver Air Midwest 6 hoses with LED light.
  - Electronic ultrasound scaler with LED light compatible with EMS®.
- Touch control panel:
  - Chair movement and movement to working positions: programmable memories (3 positions).
  - Operating light control.
  - Cup filling guide.
  - Syringe water heater.
  - Automatic sweeping of the cuspidor.
- Water/air regulation system of each hose.
- X-ray film viewer.

### • Assistant tray:

- Rotary tray
- Touch panel with controls:
  - Chair movement.
  - Cup filling guide
  - Automatic cuspidor sweep.
- Includes 4 hoses.
  - 1 Triple syringe water-air-spray.
  - 1 LED polymerization lamp.
  - 2 suction hoses type Cattani®, with 2 suction cannulas: surgical and saliva ejector.

### • Water group:

- Rotating porcelain cuspidor.
- Supported by the chair; it moves in tune with the chair.
- Incorporates water heater constant temperature 40°C.
- Mignon type cut-off valve (Inlet valve).
- Perfectly prepared for wet-ring suction, Dürr® or Cattani® type and easily adaptable to dry-ring suction.
- Tecnomed Italy pressure regulators, water, air and solid filters.
- Bottle for distilled water 1liter.

### • Motion system:

- Safety system in extreme movements, (chair and backrest lowering) and whenever the instruments are in use.
- Electro-pneumatic motor with up, down and compensated trendelenburg movements controlled from dentist tray, assistant tray and pedal.

### • Foot pedal:

- Multifunction foot pedal: Joystick for movement control. Instrument control. Control button for dental unit position, switch for cuspidor water control and switch for air and water for handpiece.

### • Lamp:

- 8000-15000Lx intensity. Power of 15W. Progressive change of light intensity.
- Color: 3000 - 4500K

### • Arm and headrest:

- Articulated arm , allow positioning in any operating area without interference.
- The headrest can be positioned upwards or downwards. Movements are made by hand at any angle. Can also be adapted for children by moving the headrest towards the backrest. Easy to use for people with reduced mobility.

### • It includes:

- Stool with height and backrest adjustment.

# HILUX M1 NEW GENERATION DENTAL UNIT

## TECHNICAL FEATURES:

ELECTRICAL PARAMETERS		POWER SUPPLY	230V/ 50Hz
		POWER CONSUMPTION	1100W
		COMPONENTS	<ul style="list-style-type: none"><li>X-Ray Viewer: 24Vac, 20W</li><li>Operating Light: 12-24Vac, 50W</li><li>Water Heater: 24Vac, 80W</li></ul>
		FUSE	<ul style="list-style-type: none"><li>F250V/T3, 15AL F250V/T6,3AL</li></ul>
WATER/AIR SET UP		AIR	<ul style="list-style-type: none"><li>Pressure: 600 - 800 kPa</li><li>Air flow: &gt; 50l/min</li><li>No oil</li></ul>
		WATER	<ul style="list-style-type: none"><li>Pressure: 200 - 400 kPa</li><li>Water flow: &gt; 10l/min</li></ul>
		VACUUM	<ul style="list-style-type: none"><li>Vacuum pressure: &lt;(-)9kPa</li><li>Flow&gt; 300l/min</li></ul>
ROTARY INSTRUMENTS	TURBINE	AIR PRESSURE	220kPa (0.2MPa)
		SPEED	350 000 rpm
	MICROMOTOR	AIR PRESSURE	300kPa (0.3MPa)
		SPEED	18 000 rpm
LIGHTING FEATURES	OPERATORY LAMP	INTENSITY	8 000 a 15 000lux (a 60cm distance)
		POWER	15W
	X-RAY VIEWER		2 000 lux
MOVEMENTS		VERTICAL MOVE	<ul style="list-style-type: none"><li>Min: 500mm</li><li>Max: 700mm</li></ul>
		BACKREST INCLINATION	105° a 170°
		HEAD EXTENSION	120 mm
		EXTENSION ANGLE	12°
		WORKSPACE	4m (L) x 2.6m (W) x 2m (H)
LOAD		DENTAL CHAIR	135kg
		INSTRUMENTS TRAY	+ -5kg
WATER HEATER TEMPERATURE			40°C (+ -5°C)
FILTERS	WATER	PARTICLES SIZE	<90um.
	AIR	PARTICLES SIZE	<25um
ENVIROMENTAL WORKING CONDITIONS		TEMPERATURE	5°C a 40°C
		RELATIVE HUMIDITY	<80% R.H 86kPa - 106kPa
TRANSPORT CONDITIONS		TEMPERATURE	-25°C a 70°C
		RELATIVE HUMIDITY	<93% R.H 50kPa - 106kPa

# HILUX M1 NEW GENERATION DENTAL UNIT

## TRANSPORT AND STORAGE CONDITIONS:

HUMIDITY:	≤ 80 %
TEMPERATURE:	-10 °C y 40°C



## DIMENSIONS:

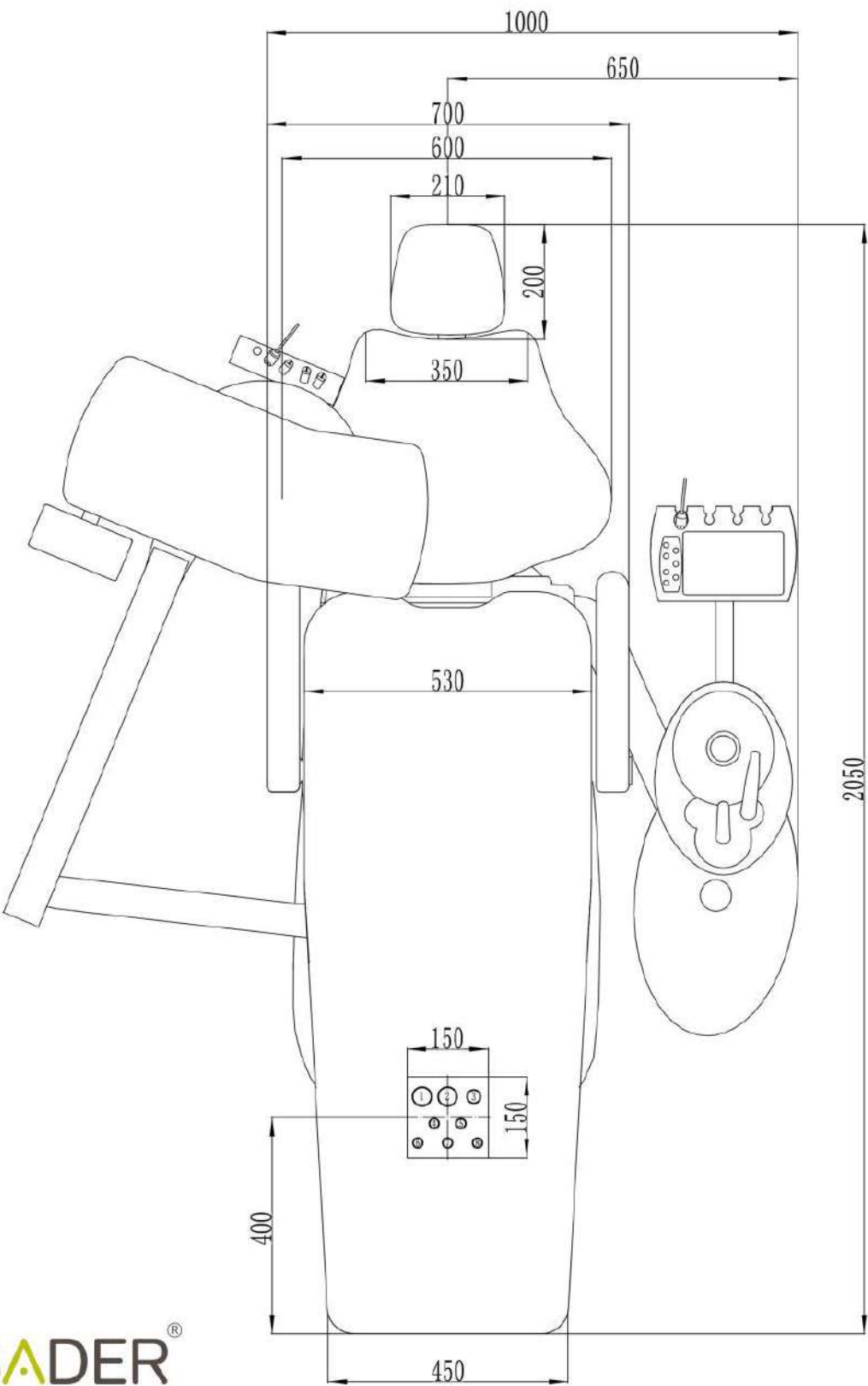

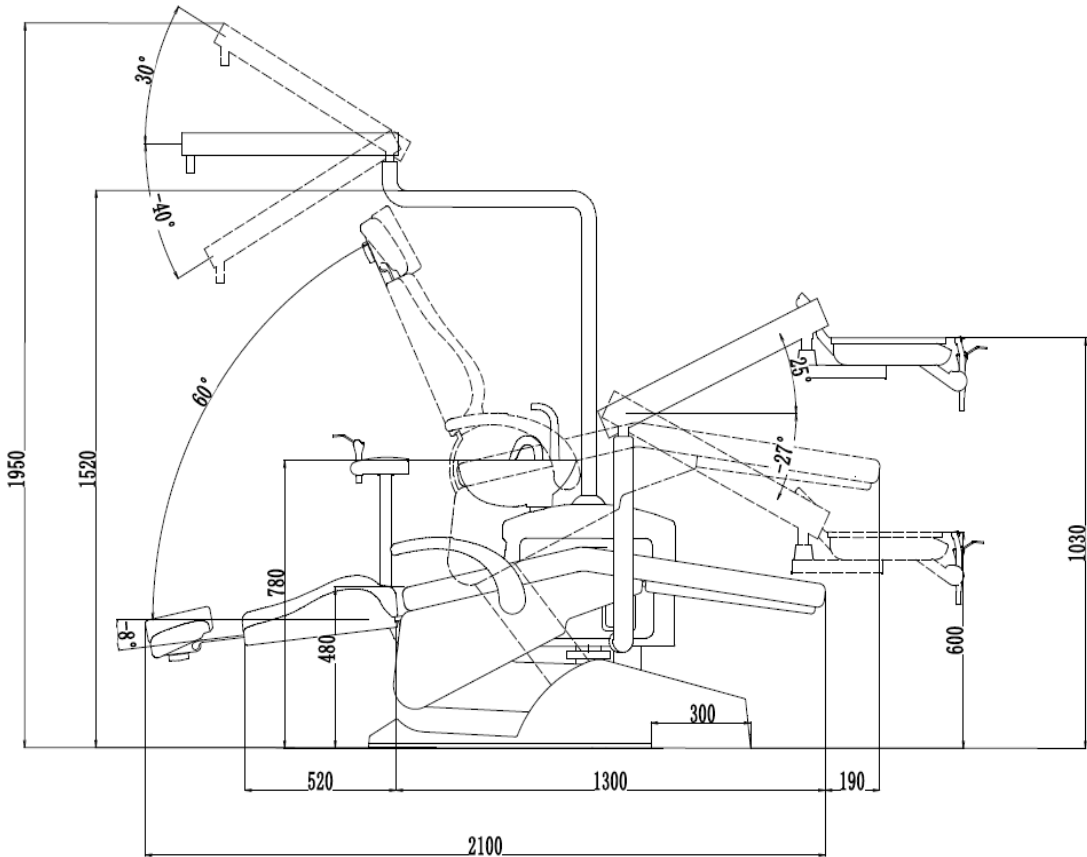
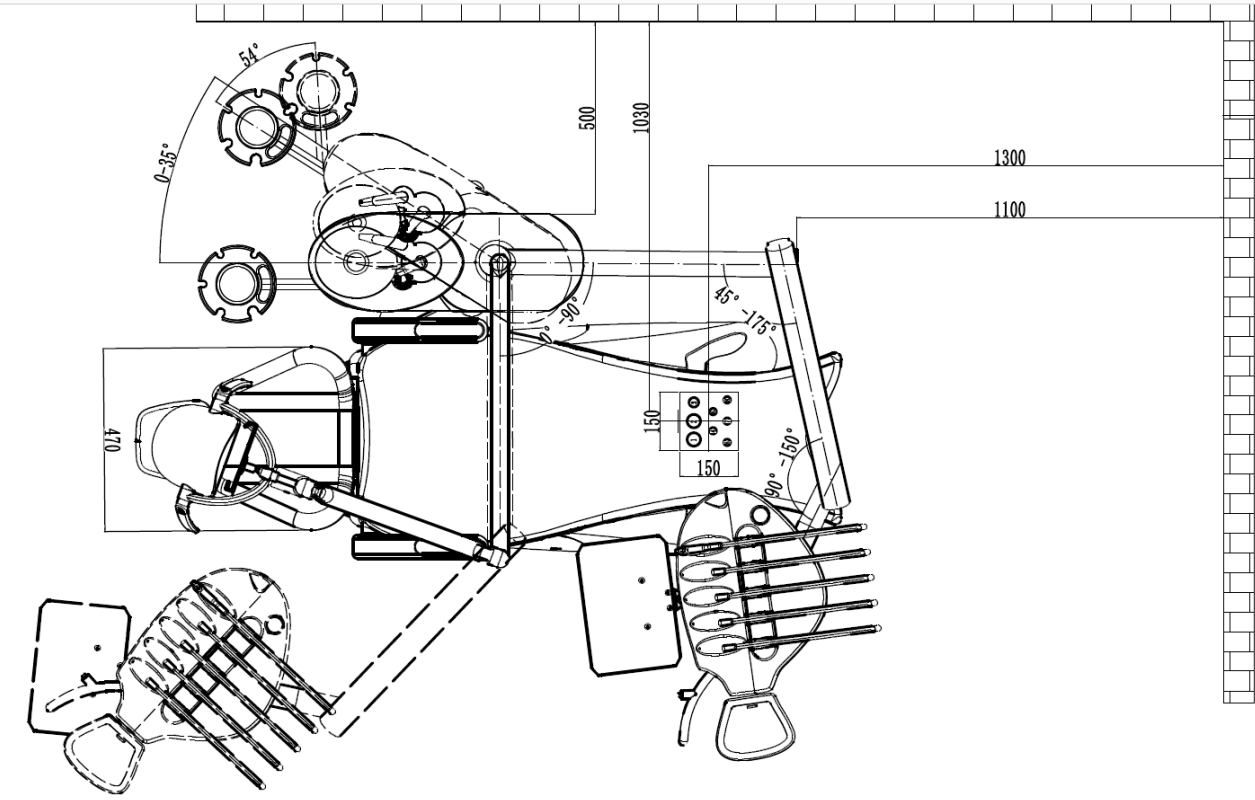

# HILUX M1 NEW GENERATION DENTAL UNIT

## INSTALLATION CONSIDERATIONS:

Connections to be made under the chair:

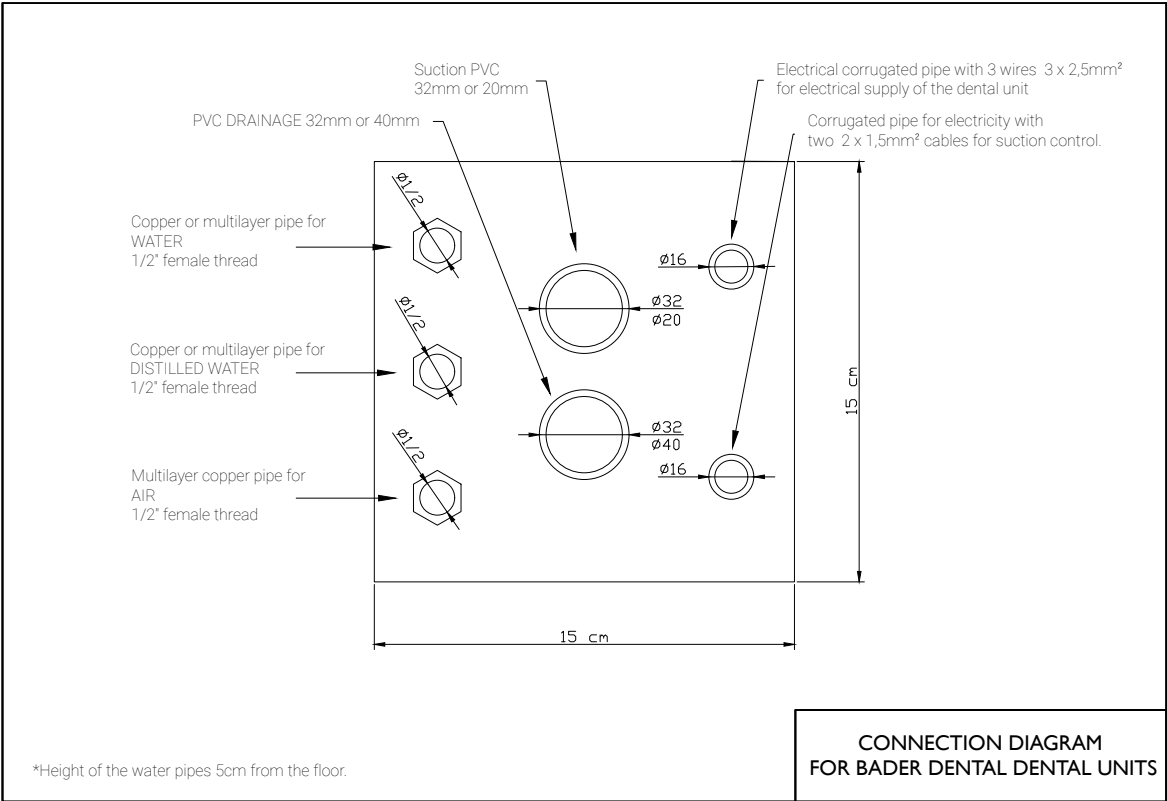

## WIRING DIAGRAM CHAIR - COMPRESSOR - SUCTION UNIT - DRAINAGE:

